



**64 Kenwood Drive, Copthorne, Shrewsbury, SY3 8SY**

4 bedroom detached house — £750,000 Freehold

## 64 Kenwood Drive, Copthorne, Shrewsbury, SY3 8SY

Coopergreenpooks.co.uk

£750,000 Freehold — 4 bedroom detached house

sales@cgpooks.co.uk

This very attractive detached family home has been significantly improved to now provide extensive and stylish accommodation with superb living space. The property is well situated in the popular Copthorne area with a private south facing garden, just a short walk from excellent schools, Quarry Park and town centre.

### KEY FEATURES

- Entrance hall providing access to the separate living and dining rooms as well as a family room that connects to a garden room/home office
- Fantastic open plan kitchen/living area with tiled flooring, large light lantern and expansive bifolding doors which open to the rear terrace and garden.
- Extensive range of modern units to kitchen area with integrated appliances, quartz work surfaces and a sizable island unit with seating area.
- Integral single garage and side entrance lobby with laundry and cloakroom.
- Staircase from hall to landing where there are 4 double bedrooms and a family bathroom. 2 of the bedrooms have impressive en suite shower rooms and the main bedroom also has a superb, fitted dressing room.
- Replacement double glazed windows and a recently installed gas central heating system.
- Extensive “in and out” driveway to front, enclosed by privacy wall which is set up for electric gates to be installed and provides secure parking for several cars
- Very attractive and private established south facing rear garden, which is mainly lawned with mature trees and beds, as well as seating areas.
- Really good location in a quiet and very convenient residential area, just a short walk from the Mytton Oak Road shopping complex, Royal Shrewsbury hospital, excellent schools, great pubs and the town centre.

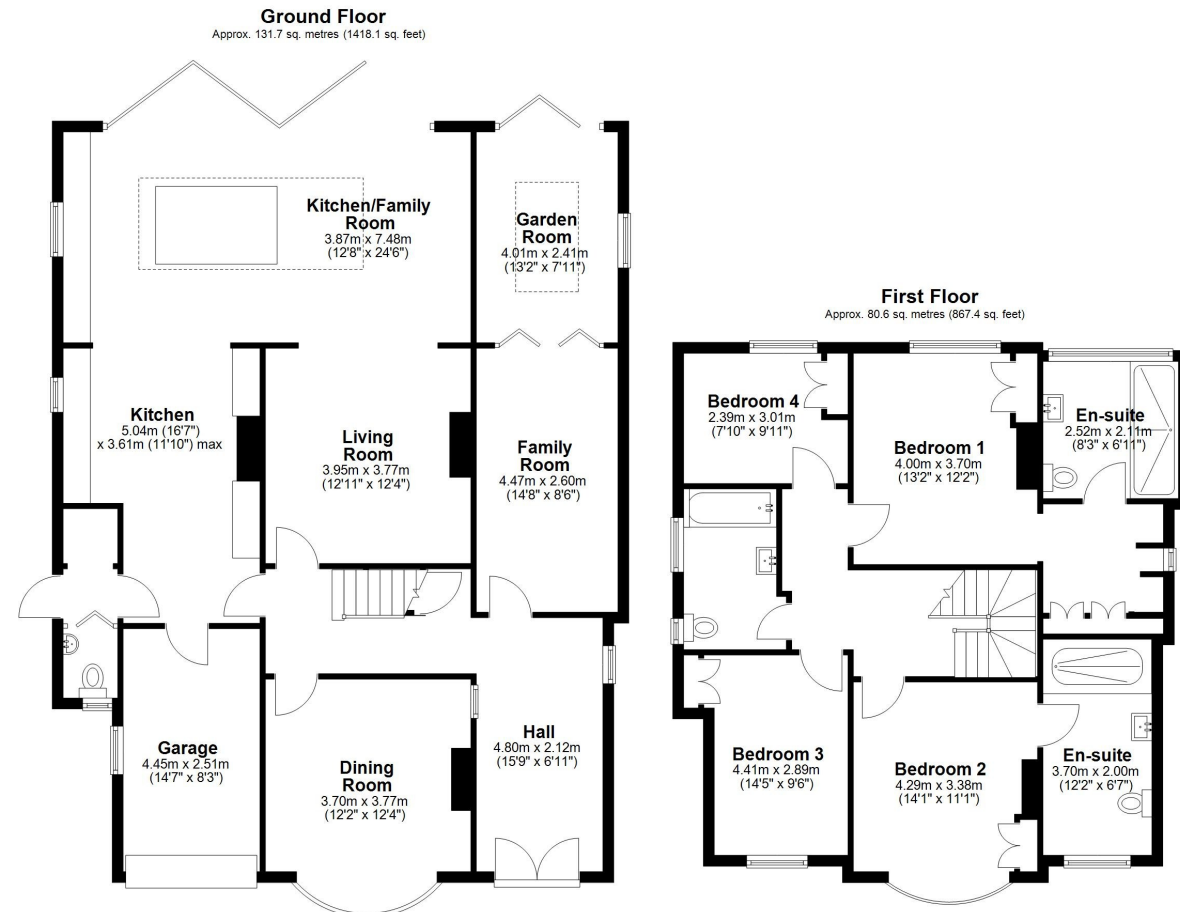

Total area: approx. 212.3 sq. metres (2285.4 sq. feet)











# 64 Kenwood Drive, Copthorne, Shrewsbury, SY3 8SY

£750,000 Freehold — 4 bedroom detached house

sales@cgpooks.co.uk

rightmove

onTheMarket.com

RICS  
Regulated by RICS

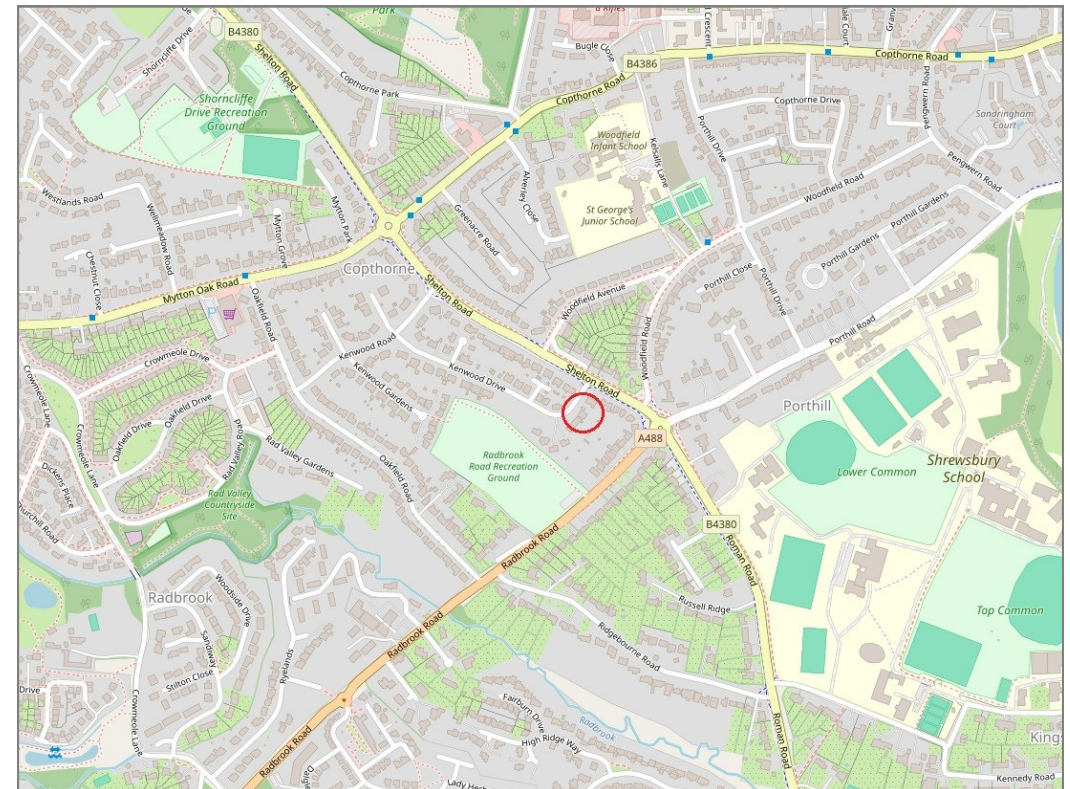

**BOUNDARIES NOT CONFIRMED**

Tenure	<b>Freehold</b>
Local Authority	<b>Shropshire Council</b>
Council Tax	<b>Band E</b>
EPC Band	<b>TBC</b>
Services	<b>All mains services are connected</b>

**Expert mortgage advice available**

3 Barker St, Shrewsbury SY1 1QF

**Cooper Green Pooks**  
**01743 276666**



Your home may be repossessed if you do not keep up repayments on your mortgage.

There may be a fee for mortgage advice. The actual amount you pay will depend upon your circumstances. The fee is up to 1% but a typical fee is 0.3% of the amount borrowed.

## 64 Kenwood Drive, Copthorne, Shrewsbury, SY3 8SY

Coopergreenpooks.co.uk

£750,000 Freehold — 4 bedroom detached house

sales@cgpooks.co.uk



**IMPORTANT NOTICE:** Cooper Green Pooks for themselves and for the lessors or vendors of this property whose agents they are give notice that: 1 No appliances, services or service installations have been tested and no warranty as to suitability or serviceability is implied. Any prospective purchaser or lessee is advised to obtain verification from their surveyor or solicitor. 2. The particulars are set out as a general outline only for the guidance of the intended purchasers or lessees and do not constitute, nor constitute part of, an offer or contract. 3. All descriptions, reference to condition and necessary permissions for use and occupation and other details are given in good faith and are believed to be correct but any intending purchasers or lessees should not rely on them as statements or representation of fact but satisfy themselves by inspection or otherwise as to the correctness of each of them. 4. No person in the employment of Cooper Green Pooks has any authority to make or give any representation or warranty whatsoever in relation to this property. 5. All rentals and prices are quoted exclusive of Stamp Duty, legal and surveyors fees and any other associated purchasers or lessees costs. 6. Floor plans are indicative only and should not be relied on. 7. The plan showing the boundary of the property is indicative only and has not been checked against the legal title so should not be relied on. 8. All dimensions, floor areas and site areas are only approximate and should not be relied on. Dimensions are generally maximum room dimension.